

► M4 SERIES ENCLOSED LIMIT SWITCHES

◆ FEATURES / 功能 :

- Miniature Size & Positive opening contact switch inserted for option.
- Wide range of choices.
- Protective grade conforms to IP 67.
- With 2m or 3m cable.(VCTF or SJTO cable).
- SJTO cable (UL approved)Oil resistance cord type.
- Standard type, Side out cable type, Quick connect type. (M12×1)
- 小型設計種類齊全與強制脫離安全開關可供選擇
- 防油、防水程度佳，符合 IP67
- 標準品附2m或3m電纜線(VCTF或SJTO電纜)
- SJTO 電纜線為 UL 認證之耐油纜線
- 標準型、側出線型、快速連結型 (M12X1)



◆ STANDARD TYPE/標準型

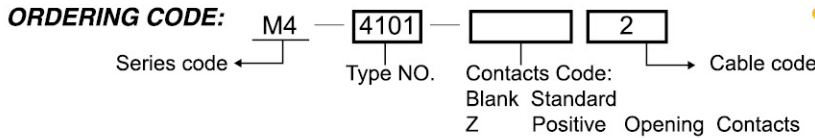

● M4-4112



Cable code : cable type ; cable length 電纜規格、長度

VCTF Cable	(0.75mm ² × 4c)	2 → 2m	3 → 3m
SJTO Cable (UL approved)	(18AWG × 4c)	2L → 2m	3L → 3m

● M4-4312



ELECTRICAL RATING

5A 125 or 250 V AC
3A 30V DC
0.4 A 125 V DC

◆ CHARACTERISTICS/特性

Operating Speed	0.1mm~0.5m/s, M4 - 4104(4114)→1mm~1m/s
Operating Temperature	-20°C~ 70°C(Without freezing)
Humidity	95% RH Max
Operating frequency	Mechanically : 120 operations/min. Electrically : 30 operations/min.
Contact resistance	300m Ω/Max. (initial) (with 3m Cable)
Insulation resistance	100M Ω/Min.(500 VDC)
Dielectric strength	Between non - continuous terminals: 1000 V AC 50/60 Hz 1 minute. Between each terminal and non - current - carrying metal part and Between each terminal and ground : 1500V AC 50/60 Hz, 1 minute.
Vibration	Malfunction durability : 10~50Hz ; 1.5mm double amplitude
Shock	Mechanical durability : 1000 m/sec ² (approx 100G'S) Malfunction durability : 300 m/sec ² (approx 30G'S)
Service life	Mechanically : 2,000,000 operations min.(Standard) 500,000 operations min. (Positive Opening Contacts) Electrically :200,000 operations min.(1.5A,110VAC)MAX.
Protection Degree	IEC : IP67

CIRCUITRY / 電氣回路

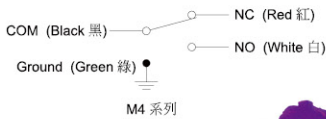

● M4-4101



● M4-4102



● M4-4311



● M4-4102R

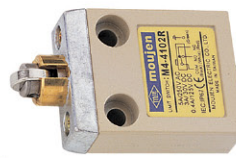

● M4-4104
● M4-4114



● M4-4111



● M4-4106



● M4-4112R



● M4-4310



● M4-4103

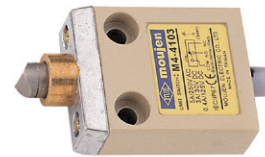

DIMENSIONS (mm)

● M4-4101

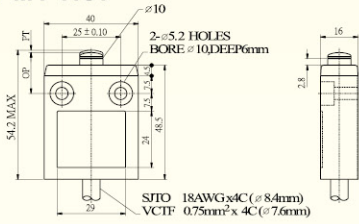

● M4-4102

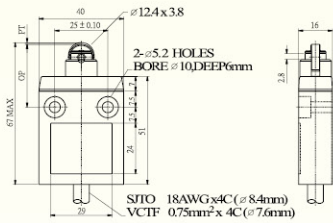

● M4-4102R

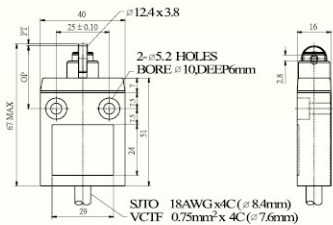

● M4-4103

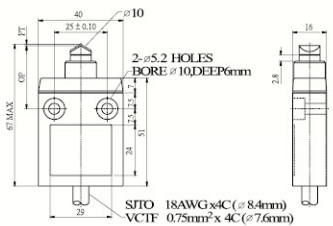

● M4-4104 ● M4-4114

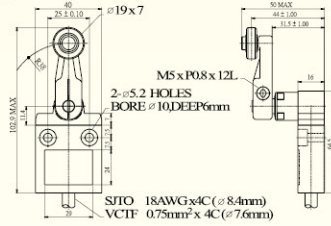

● M4-4106

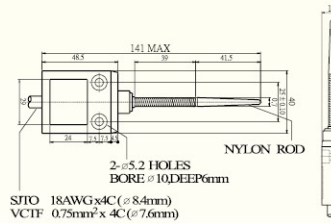

● M4-4111

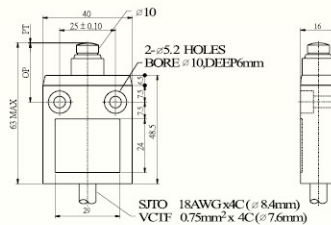

● M4-4112

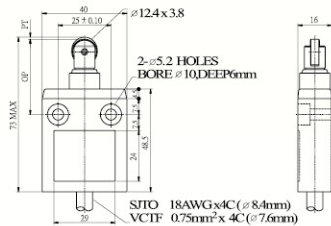

● M4-4112R

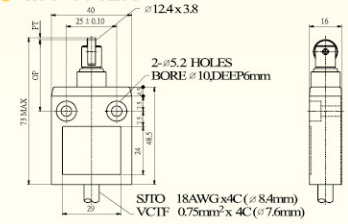

● M4-4310

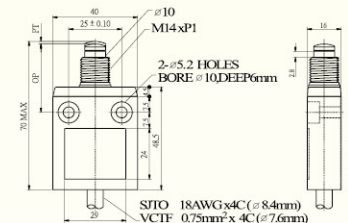

● M4-4311

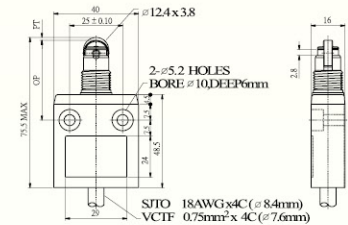

● M4-4312

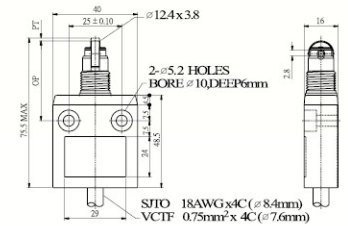

OPERATING CHARACTERISTICS

	M4-4101	M4-4102
OF MAX	1200g	1200g
RF MIN	450g	450g
PT MAX	1.8mm	1.8mm
OT MIN	3mm	3mm
MD MAX	0.2mm	0.2mm
OP	15.7±1mm	28.5±1mm

	M4-4102R	M4-4103
OF MAX	1200g	1200g
RF MIN	450g	450g
PT MAX	1.8mm	1.8mm
OT MIN	3mm	3mm
MD MAX	0.2mm	0.2mm
OP	28.5±1mm	28.5±1mm

	M4-4104	M4-4114	M4-4106
OF MAX	580g	580g	150g
RF MIN	150g	150g	*
PT MAX	25°	10° ± 3°	15°
OT MIN	40°	50°	*
MD MAX	3°	3°	*
OP	*	*	OP

	M4-4111	M4-4112
OF MAX	1800g	1800g
RF MIN	450g	450g
PT MAX	1.8mm	1.8mm
OT MIN	3mm	3mm
MD MAX	0.2mm	0.2mm
OP	24.9±1mm	34.3±1mm

	M4-4112R	M4-4310
OF MAX	1800g	1200g
RF MIN	450g	450g
PT MAX	1.8mm	1.8mm
OT MIN	3mm	3mm
MD MAX	0.2mm	0.2mm
OP	34.3±1mm	31.2±1mm

	M4-4311	M4-4312
OF MAX	1200g	1200g
RF MIN	450g	450g
PT MAX	1.8mm	1.8mm
OT MIN	3mm	3mm
MD MAX	0.2mm	0.2mm
OP	36.8±1mm	36.8±1mm

► M4 SERIES ENCLOSED LIMIT SWITCHES

◆ Side Out Cable Type: 側出線型

ORDERING CODE: M4 — 4101 S — [] 2

Series code Type NO. Contacts Code: Blank Standard Z Cable code

Positive Opening Contacts

● M4-4104S



◆ Quick Connent Type (M12×1): 快速連接器型

ORDERING CODE: M4 — 4101 Q — [] AC

Series code Type NO. Contacts Code: Blank Standard Z Connection style

Positive Opening Contacts

● M4-4102Q



● Connector Style: 連接器型式

AC → For AC or AC/DC Quick Connect Style.
DC → For DC Quick Connect Style.

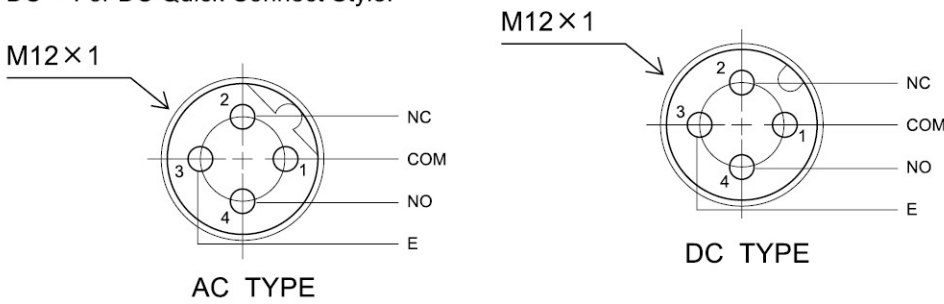

● M4-4102S



● M4-4104Z

● Connector Cable: 連結電線

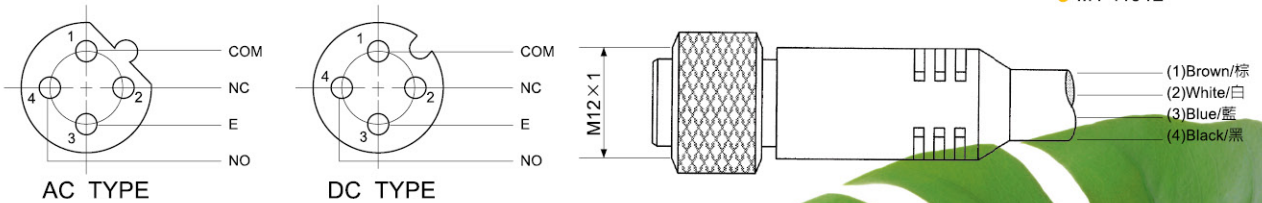
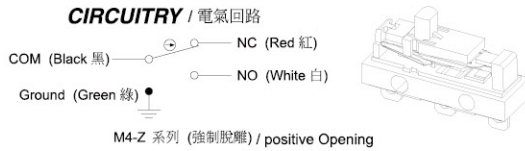

ORDERING CODE

AC TYPE	DC TYPE	Cable length 電纜長度
M4-QAC-2	M4-QDC-2	2 m
M4-QAC-3	M4-QDC-3	3 m
M4-QAC-5	M4-QDC-5	5 m